

INSTALLATION INSTRUCTIONS:

Quick Release pendant fixtures are compatible with Odyssey Line Voltage Flexible Track, Line Voltage Track and mono-point ceiling canopies. The pendants are available in four standard lengths of coaxial cord: 2', 4', 6', and 8'.

Select the appropriate fixture adapter (track or ceiling canopy) for your lighting needs. Follow instructions included with canopy for wiring and installation. Install shade onto pendant assembly (see Shade Assembly options below). Using included Hex keys, make sure the three set screws on the Quick Disconnect Plug are secure and tight. Insert Quick Disconnect Plug from pendant fixture into the adapter and twist ribbed ring to tighten (Figure 1).

SHADE ASSEMBLY:

For gravity-fit shades, thread the gravity-fit adapter ring onto the fixture, turning clockwise, until seated against bottom of the finial (Figure 2a). The smaller diameter shoulder on the adapter ring should be facing up. Next, thread on the diffuser, turning clockwise, until seated into the adapter ring (diffuser installation tool may be used). The shade slides over the cord and sits on the adapter ring. The adapter ring shoulder will center the shade on the pendant.

For lock-fit shades, the gravity-fit adapter ring is not used. If the adapter ring is pre-installed, remove the diffuser and then remove the adapter ring. At this point the LED is exposed so be careful not to contact or damage the LED. In preparation for shade installation, place diffuser in end of diffuser installation tool. Next position threaded portion of the bottom of the pendant through mounting hole on lock-fit shade (Figure 2b) Thread diffuser onto pendant from the bottom of the shade using diffuser installation tool. Tighten until snug but do not overtighten.

Note: Maximum weight of shade not to exceed 4 lbs.

SHORTENING PENDANT CORD LENGTH:

1. Determine desired exposed cord length (e.g. 48")
2. Add 2" to desired exposed wire length and mark cord (e.g. 50")
3. Cut cord at mark.
4. Remove Quick Disconnect Plug from excess remaining cord by removing 1.5mm hex key set screw (A) and the 3mm hex key set screw (Figure 3). Do not remove 1.5mm set screw (B). The Quick Disconnect Plug may now be separated from the cord.
5. Strip 1-3/8" of insulation only from cord leaving the braided wire in place.
6. Remove only 1" of braided wire, leaving behind 3/8" of the braided wire exposed.
7. Strip the inner stranded wire 1/8".
8. Fold back the braided wire over the coaxial wire jacket, place stripped wire end into the Quick Disconnect Plug. **Push the wire all the way in until the stripped inner stranded wire is visible through the 1.5mm screw hole opening (A)** in the tip of the plug and the cord jacket is visible in the 3mm screw hole, rotate the wire so that the braid is visible.
9. **NOTE: The cord braid and jacket under it must be visible in the 3mm screw hole to ensure a properly secured pendant.** With wire in place, fasten 3mm hex key set screw until tight and cord is secure.
10. **Confirm stripped inner stranded wire is still visible in opening (A)** and then fasten 1.5mm hex key set screw in opening in plug tip.
11. Make sure ALL set screws are secure and tight.
12. Install shade onto pendant assembly (see Shade Assembly above). Insert Quick Disconnect Plug from pendant fixture into the adapter and twist ribbed ring to tighten (Figure 1).

Continued

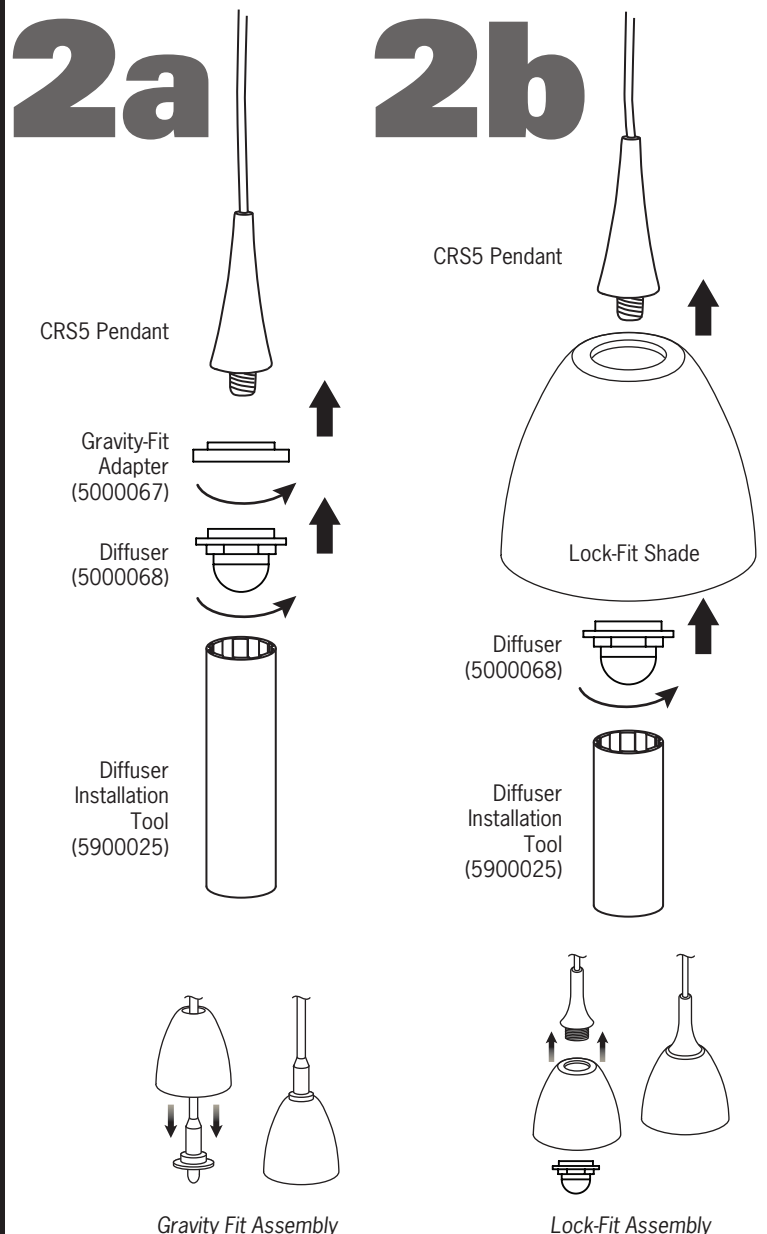
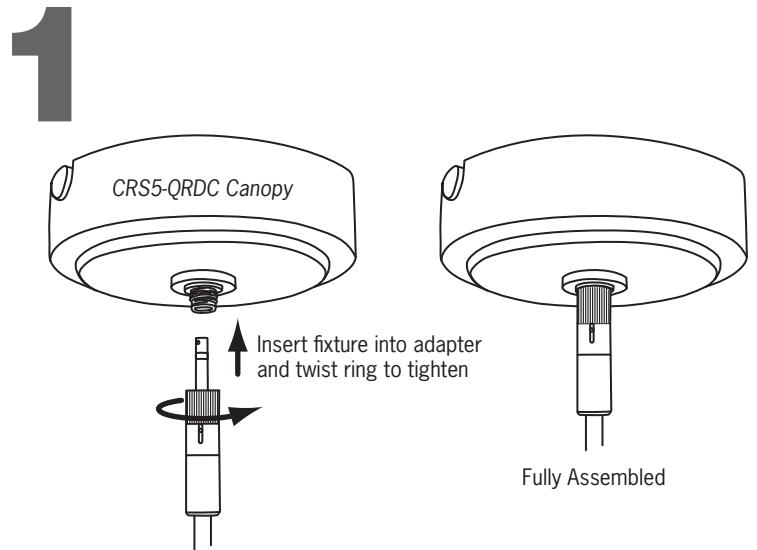

IMPORTANT SAFETY INSTRUCTIONS:

- Read all the instructions before installation. Save instructions for later use.
- Turn off power at fuse or circuit breaker box before installation or before doing any maintenance work.
- Product must be mounted in locations and at heights in a manner consistent with its intended use, and in compliance with National Electrical Code and local building codes. For indoor use only.
- Product must be grounded to avoid potential electric shock and any other potential hazards.
- Do not exceed the nominal supply voltage or amperage ratings.
- Make sure all screws are properly tightened.
- Installing contrary to instructions may cause unsafe conditions.
- **Warning:** Risk of fire. Most dwellings built before 1985 have supply wire rated at 60°C. Consult a qualified electrician before installation.
- To avoid hazards to children, account for all parts and properly dispose of all packing materials.
- Call the Technical Support department at ConTech Lighting with any installation questions: 847-559-5500.

3

