

INSTALLATION INSTRUCTIONS | Eclipse Curve Track Mount Luminaires: CTL905* Series

Note: Before attempting installation please refer to your local electrical code

IMPORTANT SAFETY INSTRUCTIONS:

Installation, inspection and maintenance of this luminaire must be carried out by a qualified electrician. Read all the instructions before installation. Save instructions for later use.

When installing or using this luminaire, all basic safety precautions, warnings, restrictions and recommendations must be followed, including the following:

- Turn off power at fuse or circuit breaker box before installation and before performing any maintenance work.
- Product must be grounded to avoid potential electric shock and any other potential hazards.
- Wear rubber soled shoes, proper safety glasses and gloves, and work on a sturdy wooden or non-conductive ladder.
- Product must be mounted in locations and at heights in compliance with the NEC and all local building codes.
- Installing contrary to instructions may cause unsafe conditions.
- For indoor use only, suitable for damp locations.
- Do not exceed the nominal supply voltage or amperage ratings.
- Do not install any luminaire assembly closer than 6 inches from any curtains or combustible materials.
- Do not mount near gas or electric heaters.
- Do not block the light from the trim aperture, in whole or in part, as this may cause unsafe conditions.
- Make sure the supply voltage is the same as the rated luminaire voltage.
- Do not operate in ambient temperatures above those specified for the luminaire.
- Avoid direct eye contact with the light source.
- Always support the weight of the luminaire.
- Use correctly rated supply conductors as indicated by the luminaire labeling.
- Equipment should be mounted in location and at heights where it will not readily be subject to tampering by unauthorized personnel.
- To avoid hazards to children, account for all parts and properly dispose of all packing materials.
- **WARNING:** Risk of fire. Most dwellings built before 1985 have supply wire rated at 60°C. Consult a qualified electrician before installation.
- Call the Technical Support Department at ConTech Lighting with any installation questions: 847.559.5500

INSTALLATION PROCEDURES: TRACK MOUNTING FOR SINGLE-CIRCUIT TRACK

1. All track sections have an easy-to-see embossed polarity line (Figure 1).
2. The fixtures have indicator arrows designed to point to the track polarity line (Figure 2).
3. To install:
 - A. Insert the fixture contacts into the track channel
 - B. Retract the track latch by gently pulling down
 - C. Rotate the adapter 90° so that the polarity arrow points to the polarity line on the track (Figure 3)
4. When the fixture is installed, the track latch will lock the luminaire into the track.

NOTE: All latches should face the same direction after installation. Once the luminaire is installed into the track, move the ON/OFF switch to the "ON" position.

FIGURE 1

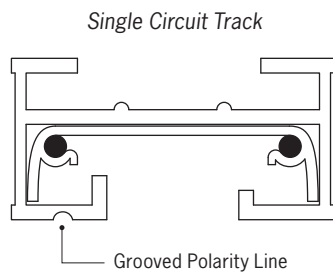

FIGURE 2

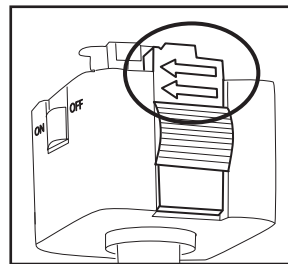
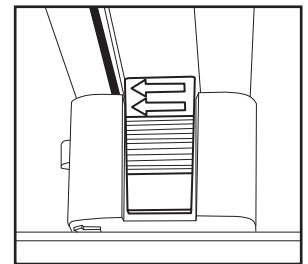

FIGURE 3



All specifications subject to change without notice. For ConTech's limited product warranty, go to www.contechlighting.com. For a printed copy of the warranty, call 1-847-559-5500.

CONTECH LIGHTING | 725 LANDWEHR ROAD | NORTHBROOK, ILLINOIS 60062 | PHONE 847.559.5500 | www.contechlighting.com

©2025 Conservation Technology of Illinois, LLC. All rights reserved. Note: Specifications subject to change without notice.

CTL905 INST REV0321

INSTALLATION INSTRUCTIONS | Eclipse Curve Track Mount Luminaires: CTL905* Series

Note: Before attempting installation please refer to your local electrical code

INSTALLATION PROCEDURES: TRACK MOUNTING FOR TWO-CIRCUIT TRACK

The luminaires have two contacts in the connector that engage conductors within the track; one for neutral and the other for the positive (live) conductor. Two-circuit Track contains one neutral and two positive conductors. To engage the second live conductor (Figure 4):

1. Identify the "POSITIVE" connections on the lighting fixture base, marked "P"
2. To access the second circuit, pull up the connector marked "P" to the position shown
3. Slide the plastic shim (shipped with track) beneath the connector, locking the tabs in place
4. All Two-circuit track sections have an easy-to-see embossed polarity line (Figure 5)
5. The fixtures have indicator arrows designed to point to the track polarity line (Figure 6)
6. To install:
 1. Insert the fixture contacts into the track channel
 2. Retract the track latch by gently pulling down
 3. Rotate the adapter 90° so that the polarity arrow points to the polarity line on the track (Figure 7)
7. When the luminaire is installed, the track latch will lock the luminaire into the track.

NOTE: All latches should face the same direction after installation. Once the luminaire is installed into the track, move the ON/OFF switch to the "ON" position.

FIGURE 4

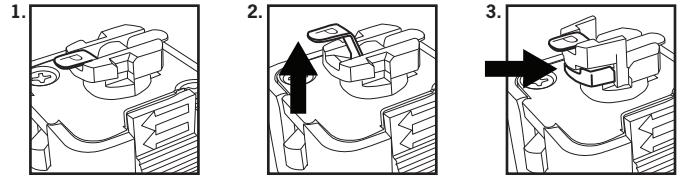

FIGURE 5

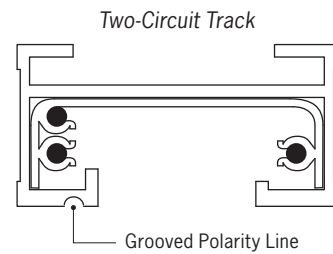

FIGURE 6

Track Latch with Polarity Arrows

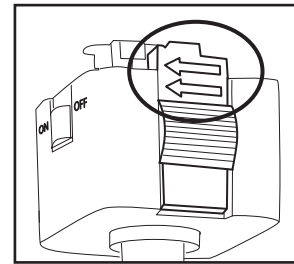
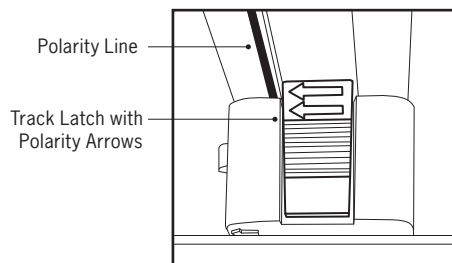

FIGURE 7



All specifications subject to change without notice. For ConTech's limited product warranty, go to www.contechlighting.com. For a printed copy of the warranty, call 1-847-559-5500.

CONTECH LIGHTING | 725 LANDWEHR ROAD | NORTHBROOK, ILLINOIS 60062 | PHONE 847.559.5500 | www.contechlighting.com

©2025 Conservation Technology of Illinois, LLC. All rights reserved. Note: Specifications subject to change without notice.

CTL905 INST REV0321