

For ConTech Lighting Recessed Track Housing System
For use with ConTech Single and Two-Circuit LT Series Track and LA Series End Feed/Feed Connectors only

ASSEMBLED VIEW:

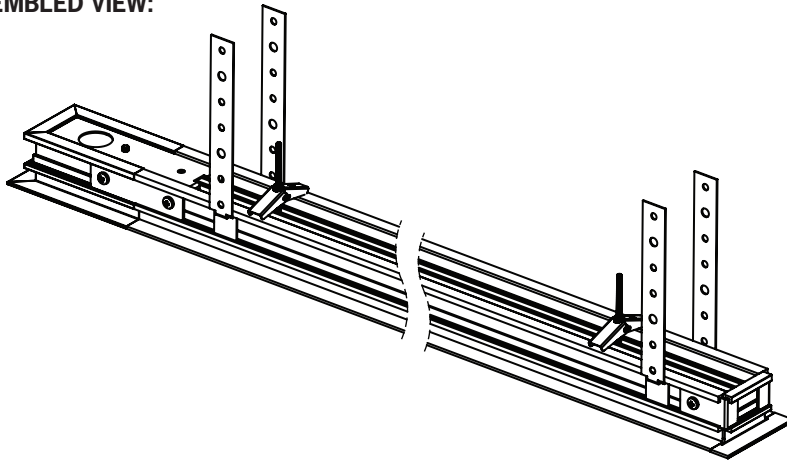

EXPLODED VIEW:

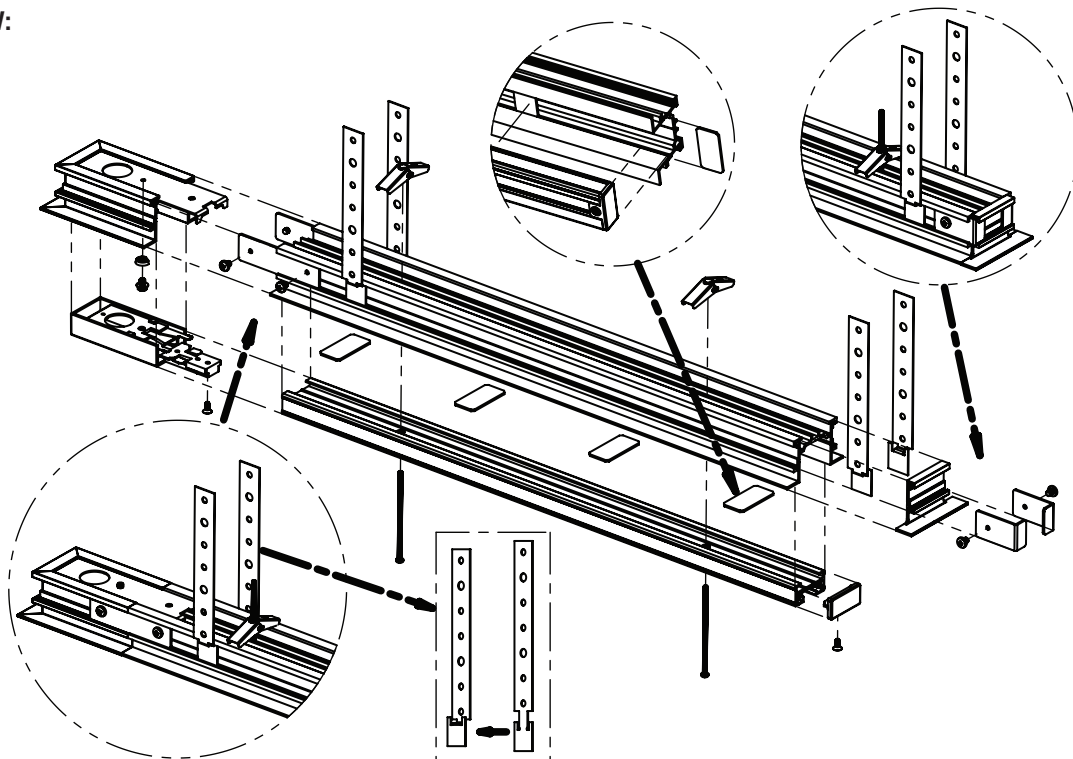

NOTICE: Plan job to ensure all required parts, components, and hardware are present before starting installation. The basic components needed for installation, including quantities of each, depends upon the specific layout.

RECESSED TRACK HOUSINGS (sold individually):

1. **RTH-4:** Housing for 4' track section (For use with LT-4 or LT-24, sold separately)
2. **RTH-8:** Housing for 8' track section (For use with LT-8 or LT-28, sold separately)

CONNECTOR HOUSINGS (sold individually):

1. **RAH-2:** Straight Connector Housing, for use with LA-12 or LA-212
2. **RAH-10:** End Feed Housing, for use with LA-10 or LA-210
3. **RAH-11:** Dead-End Piece, for use with RTH-4 and RTH-8 Housing
4. **RAH-12:** "L" Connector Housing, for use with LA-12 or LA-212

5. **RAH-13:** "T" Connector Housing, for use with LA-13, LA-14, LA-213 or LA-214
6. **RAH-15:** "X" Connector Housing, for use with LA-15 or LA-215

PROVIDED HARDWARE (provided with each Recessed Track Housing segment):

1. Four (4) 6-1/4" long mounting tabs (for use with RTH-4)
2. Six (6) 6-1/4" long mounting tabs (for use with RTH-8)
3. Two (2) 3" long connecting tabs. Each provided with 2 set screws.
4. Four (4) 1-1/2" long tabs for depth adjustment
5. Two (2) 1-3/8" long end-piece "L" mounting bracket. Each provided with 1 set screw.

All specifications subject to change without notice. For ConTech's limited product warranty, go to www.contechlighting.com. For a printed copy of the warranty, call 1-847-559-5500.

For ConTech Lighting Recessed Track Housing System
For use with ConTech Single and Two-Circuit LT Series Track and LA Series End Feed/Feed Connectors only

RECESSED TRACK HOUSING INSTALLATION PROCEDURES:

CAUTION: The RTH-4 and RTH-8 are only to be used with fittings identified for use with this system and as covered in these instructions. Please refer to these instructions for field cutting/drilling.

1. Read the "IMPORTANT SAFETY INSTRUCTIONS" at the bottom of these instructions before proceeding.
2. The 4 or 8-foot recessed track housing (RTH-4 and RTH-8 respectively) may be suspended with the provided 6-1/4" long mounting tabs. It is recommended to use one mounting tab set each 36" of track housing.
3. The mounting tabs are attached to the housing system by bending the tab portion at a right angle (where it joins the perforated section) and inserting the tabs into the channel in each side of the housing extrusion. The mounting tabs must be installed prior to assembling the RAH-11 end cap or a RAH-2, RAH-10, RAH-12, RAH-13, RAH-15 housing. Attach the tabs to any firm component of the ceiling system. For a T-bar ceiling, suspend the housing to the permanent ceiling, making sure the bottom of the housing is leveled with the bottom of the T-bar. Use bottom outer edge of housing as "T-bar" for that side of the ceiling tile.
4. Alternatively, the recessed track housing (fully assembled with its corresponding LT track) can be secured to drywall with the provided bolts and anchors (2 for each RTH-4 and 3 for each RTH-8) or into a wood support structure with #10 wood screws (not provided). If wood screws are used, drill the appropriate number of holes at the top of the housing extrusion and mount with the wood screws mentioned above.
5. The recessed track housing may be cut in the field to required lengths. A straight squared cut is necessary to insure proper fit. See Item 2 under "Track Installation Procedures" for further information.
6. The bottom edges of the housing flange should overlap the ceiling surface.
7. Four 1-1/2" long tabs must be inserted into the channel inside of the housing to create a depth adjustment when single-circuit track is installed. These parts are discarded when two-circuit track is installed.
8. When using two or more recessed track housings in a run with an RAH-2 and/or a RAH-10, RAH-12, RAH-13, RAH-15 housing, use the two 3" long connecting tabs provided, which slide into the channel in each side of the housing extrusion. Place the connecting tabs into the slot on one housing and tighten set screws. Insert the connecting recessed track housing and/or a RAH-2, RAH-10, RAH-12, RAH-13, RAH-15 housing over the protruding connecting tabs, push flush, and securely tighten other set screws. The set screws will bite into the paint, grounding the RAH housings to the recessed track housing.
9. Each run, or individual track housing, is completed with a dead-end piece (RAH-11) mounted to the open end of the housing with the two 1-3/8" end piece "L" mounting brackets provided. The two short portions of the brackets are inserted into the dead-end piece and the two long portions will fit into the open end of the housing, utilizing the channel in each side of the housing extrusion, and are locked into place with the set screws. Securely tighten the set screws. The set screws will bite into the paint, grounding the RAH-11 dead-end piece to the recessed track housing.

TRACK INSTALLATION PROCEDURES:

CAUTION: The LT Series Tracks are only to be used with electrical fittings identified for use with the track system. Please refer to the LT Series Single and Two-Circuit installation instructions for field cutting / drilling, which must be used in conjunction with these instructions.

1. Mounting holes (2 per 4-foot section and 3 per 8-foot section) are provided to install and securely fasten the LT track into the recessed track housing by use of the anchor and bolts provided.
2. Keep the track end cap (provided with each track) in place when making the end feed connection mentioned under Item 3 below and when installing the RAH-11 dead-end piece to the recessed track housing under Item 9 above. With the track end cap in place, a gap is present between the RAH-11 dead-end piece and recessed track housing. However, the LT track must be cut, and the edges deburred, to eliminate the gap and to ensure proper fit. After doing so, the end cap must be re-installed. For on-going connections, remove the end cap. However, the last piece of track in a run must have the end cap in place.
3. Firmly insert the end feed (LA-10 or LA-210) into single or two-circuit track (the small arrow on the lead end should point to the polarity line), install the RAH-2 connector housing after removing the 1/2 inch knockout, remove the LA-10 or LA-210 cover to access wiring connections, follow the "Electrical Power Connections" below, reinstall cover per Item 6, and install the RAH-11 dead-end piece.
4. When more than one track length is used in a run, the mini connector (LA-2 or LA-202) may be used to connect track sections. When these connectors are used, no additional connector housings are required. If an additional feed is required in a straight run, then use the full size straight connector (LA-12 or LA-212) with the RAH-2 straight connector housing. For 90-degree connections, the LA-12 or LA-212 can also be utilized with a RAH-12 "L" connector housing. The LA-12 and LA-212 come equipped with a 90-degree cover and are provided with a separate straight cover. When using an LA-15 and LA-215, the RAH-15 "X" connector housing is to be used. When using a LA-10 or LA-210, the RAH-10 end feed housing is to be used.
5. Replace cover of all end feeds and/or connectors ensuring proper fit.

For ConTech Lighting Recessed Track Housing System
For use with ConTech Single and Two-Circuit LT Series Track and LA Series End Feed/Feed Connectors only

ELECTRICAL POWER CONNECTIONS:

CAUTION: The LA Series End Feed Connector installation instructions must be used in conjunction with these instructions for proper electrical power connections and grounding.

1. This track system is to be supplied by a single 120V, 60Hz, 20A max branch circuit with ground.
2. Do not use a power supply cord or a convenience receptacle or adapter. Only use with an approved flexible or rigid conduit.
3. Attach flexible or rigid conduit (with their appropriate fittings) to the 1/2 inch knock out provided in the recessed straight connector housing (RAH-2) or end feed housing (RAH-10).
4. Pull the branch power and ground leads through and connect to the terminal screws provided in the Con-Tech Single or Two-Circuit end feeds (LA-10 or LA-210) or any of the feed connectors (LA-12, LA-212, LA-13, etc.). In addition to securing the ground lead to the terminal of the end feed or feed connector, the ground lead must be long enough to also provide grounding of the RAH/RTH housings via the ground screw and cup washer provided in each RAH housing. The ground screw and cup washers are provided loosely with each RAH housing and must be installed.
5. Electrical installation must be made in accordance with the NEC and local building codes.

IMPORTANT SAFETY INSTRUCTIONS

- Read all installation instructions before installing the recessed track housing system.
- **SAVE THESE INSTRUCTIONS** and refer to them when additions to or changes in the recessed track housing system configuration are made.
- **WARNING:** Risk of fire. Most dwellings built before 1985 have supply wire rated at 60°C. Consult a qualified electrician before installation.
- Turn off the power at the fuse or circuit breaker box before installation, any maintenance work, or adding or changing the configuration of the recessed track housing system.
- Wear rubber soled shoes and work on a sturdy wooden or non-conductive ladder.
- Product must be mounted in compliance with NEC and local building codes.
- For indoor use only. Do not install in damp or wet locations.
- Do not exceed the nominal supply voltage or amperage ratings.
- Do not install any part of the recessed track housing system less than 5 feet above the floor.
- Do not install any part of this system closer than 6 inches from any curtain, or similar combustible material.
- Do not attempt to energize anything other than the lighting track luminaires on the track. To reduce the risk of fire and electric shock, do not attempt to connect power tools, extension cords, appliances, and the like to the track.
- Do not connect a track to more than one branch circuit unless the track is constructed so that it can be used with more than one branch circuit. Check with a qualified electrician. Although the track lighting system may seem to operate acceptably, a dangerous overload of the neutral may occur and result in a risk of fire.
- Installing contrary to instructions may cause unsafe conditions.
- Avoid hazards to children and account for all parts and properly dispose of all packing materials.
- Call the Technical Support department at ConTech Lighting with any installation questions.