

# CTGATLG3

## ATLAS GRANDE

### Glass Cylinder Gravity-Fit Shade

ATLAS GRANDE Glass Cylinder Shades offer a taller version of our classically simple ATLAS Shades. These shades are perfect when additional scale is desired and can be paired with our RLM80 Modern Pendant/LED Filament Lamp combinations, especially the T10 lamp. The frosted white finish is recommended for use with our CRS8 LED Integrated Pendant. These shades are designed for use with ConTech's Gravity-Fit pendants and include a new slotted mounting ring to facilitate installation.

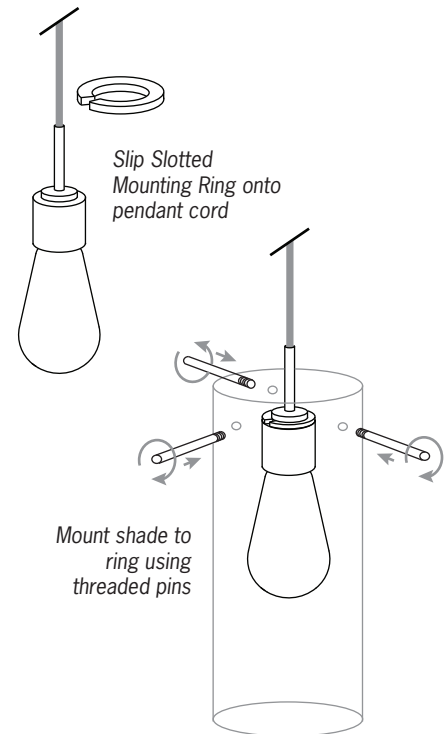

Shown with MEGAMAN T10 LED Filament Lamp (P/N LG218025/DME26-822)

### Ordering Information

Example Order:

Shade	Finish
<input type="text"/>	<input type="text"/>
<b>CTGATLG3</b> - ATLAS GRANDE Glass Cylinder with Mounting Ring	<b>A</b> - Amber <b>C</b> - Clear <b>W</b> - Frosted White

