

DATE

PROJECT

TYPE

# TLPWM | Wall Mount Bracket for Performance LED Tapelight

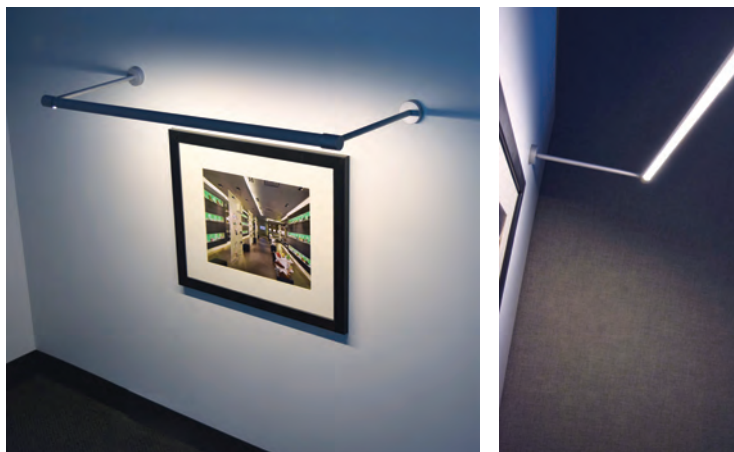

Overhead View

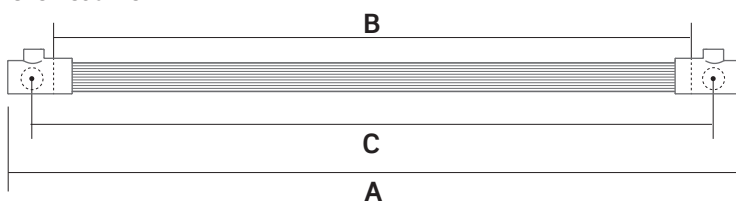

A Overall Length	B Extrusion Length	C Centered Mntg Loc
12"	10"	11"
24"	22"	23"
36"	34"	35"
48"	46"	47"
60"	58"	59"
72"	70"	71"

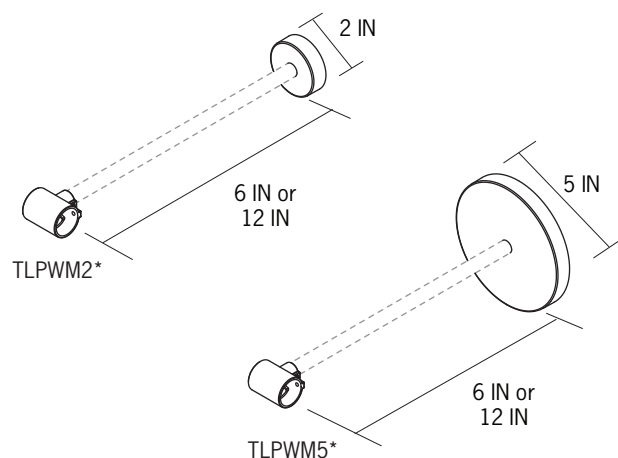

\*Stems sold separately

## Product Details

### Features

- Create a unique Wall Mount luminaire simply by combining the Wall Mount Brackets, Round Mounting Channel and any of ConTech's Performance LED Tapelight Series
- Provides excellent heat sinking and protection to the LEDs while ensuring a clean, straight run
- Not compatible with TLTO Outdoor Performance LED Tapelight or 120V Flex LED Strip Light Series
- For use with TLACO6: ConTech's Round Mounting Channel
- Bracket assembly includes canopy, elbow, mounting plate and mounting hardware. Stem and Round Mounting Channel sold separately.

- Field cuttable Stem and Round Mounting Channel
- Lockable aiming: channel can be rotated to direct illumination in any direction
- Clear or frosted lens can be added to cover LEDs
- cCSAus Certified to UL standards
- Suitable for dry or damp locations; not suitable for wet locations
- Not suitable for Ceiling Mount

### Warranty

- Covered by ConTech's five (5) year replacement guarantee when tapelight is installed using the aluminum mounting channel.

DATE

PROJECT

TYPE

# TLPWM | Wall Mount Bracket for Performance LED Tapelight

## Sample Component List

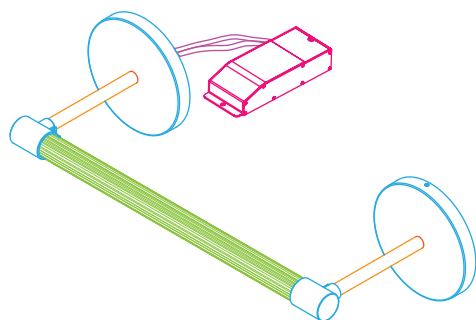

### Sample Component Order List

- (2) Wall Mount Brackets
- (2) Stems
- Desired length of Round Mounting Channel
- (1) Power Supply: 12V or 24V Hardwire or Plug-in
- (1) Power Connector: 12V or 24V Hardwire or Plug-in
- Appropriate length of 12V or 24V Performance LED Tapelight
- Appropriate length of Diffusion Lens

## Ordering Information: Components Needed for Full Assembly

### Round Mounting Channel



**TLAC06** - 6 Ft Round Channel, Aluminum  
**TLAC06-B** - 6 Ft Round Channel, Black

Quantity

### Diffusion Lenses

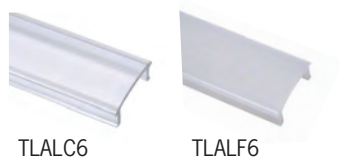

TLALC6

TLALF6

**TLALC6** - 6 Ft Clear Lens  
**TLALF6** - 6 Ft Frosted Lens

Quantity

### Wall Mount Brackets

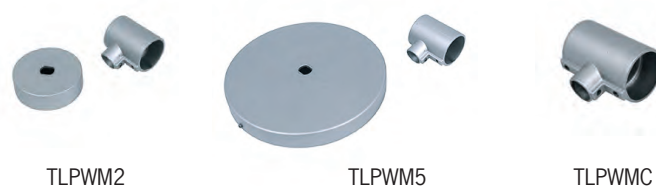

TLPWM2

TLPWM5

TLPWMC

**TLPWM2-S** - 2" Wall Mount Bracket, Aluminum  
**TLPWM2-B** - 2" Wall Mount Bracket, Black  
**TLPWM5-S** - 5" Wall Mount Bracket, Aluminum  
**TLPWM5-B** - 5" Wall Mount Bracket, Black  
**TLPWMC2-S** - 2" Center Support Wall Mount Bracket, Aluminum  
**TLPWMC2-B** - 2" Center Support Wall Mount Bracket, Black  
**TLPWMC5-S** - 5" Center Support Wall Mount Bracket, Aluminum  
**TLPWMC5-B** - 5" Center Support Wall Mount Bracket, Black

Quantity

### Wall Mount Bracket Stems



**WMSTEM6-S** - 6" Stem, Aluminum  
**WMSTEM6-B** - 6" Stem, Black  
**WMSTEM12-S** - 12" Stem, Aluminum  
**WMSTEM12-B** - 12" Stem, Black

Quantity

DATE

PROJECT

TYPE

# PERFORMANCE LED TAPELIGHT | 12V Power Supplies

## 12V Plug-In Power Supplies



**TLP12VP24**  
 12V/24W Plug-and-Play Power Supply  
 120VAC/12VDC. Includes AC wall plug and female power output barrel plug for easy installation.  
 3-1/4" L x 1-3/4" W x 1-1/4" D  
 System length: 6'  
 Use with 12V Performance LED Tapelight



**TLP12VP Series**  
 12V Plug-and-Play Power Supplies  
 120VAC/12VDC. Includes AC wall plug and female power output plug for easy installation.  
 4" L x 2" W x 1-1/4" D  
 Use with 12V Performance LED Tapelight

**TLP12VP24** - 12V/24W Plug-and-Play Power Supply **Quantity**

**Power Supply/Wattage** **Quantity**  
**TLP12VP36** - 36W, System Length 10'  
**TLP12VP60** - 60W, System Length 12'

## 12V Hardwire Power Supplies



**TLP12VHW Series**  
 Hardwire Power Supply  
 120VAC/12VDC. Includes stripped and tinned wire pigtailed on the input and output sides. **MUST BE MAINTAINED WITHIN AN ENCLOSURE THAT MEETS LOCAL BUILDING CODES AND NEC (SUPPLIED BY OTHERS).** 2' Wire leads. Class 2 recognized.  
 Use with 12V Performance LED Tapelight



**TLP12VHW \* MV-ENC Series**  
 Hardwire Class 2 Constant Voltage Driver  
 120 – 277VAC/12VDC Dimming and non-dimming Class 2 Constant Voltage LED Drivers. UL Listed enclosure with built-in junction boxes. No minimum load requirement. Auto-reset protection for short circuit and over-temperature. Over load protection in CC mode. 0-10V Dimming driver delivers smooth flicker free linear dimming down to 1% with most LEDs and a wide variety of compatible dimmers. Suitable for both indoor and outdoor installations.  
 Use with 12V Performance LED Tapelight

**TLP12VHW20** **Quantity**  
 20W 12V 120VAC: 4-3/4" L x 1-3/16" W x 1" D  
**TLP12VHW60**  
 60W 12V 120VAC: 6-1/2" L x 1-3/4" W x 1-1/4" D

**TLP12VHW50MV-ENC** **Quantity**  
 50W 12V 120-277VAC, Non-Dimming Driver  
**TLP12VHW50MVD2-ENC**  
 50W 12V 120-277VAC, 0-10V Dimming Driver



**TLP12VHW \* -ENC Series**  
 Hardwire Class 2 Enclosed Driver  
 120VAC/12VDC. Dimmable Class 2 listed driver. Compact self-enclosed driver with two (2) knockouts. Auto Reset and short circuit protection. Dimmable with standard MLV/Incandescent TRIAC (leading edge) dimmers; 8W min. load required for smooth dimming.  
 6-3/4" L x 2-5/8" W x 1-1/4" D  
 Use with 12V Performance LED Tapelight, not to be used with RGB tapelight series.

**TLP12VHW20-ENC** - 20W 12V 120VAC **Quantity**  
**TLP12VHW60-ENC** - 60W 12V 120VAC

DATE

PROJECT

TYPE

# PERFORMANCE LED TAPELIGHT | 24V Power Supplies

## 24V Plug-In Power Supplies



### TLP24VP Series

#### Plug-and-Play Power Supply

120VAC/24VDC. Includes AC wall plug and female power output barrel plug for easy installation. Class 2 listed.

For use with 24V LED Tapelight.

#### Power Supply/Wattage

Power Supply/Wattage	Quantity
<b>TLP24VP36</b> - 36W 4-1/4" L x 2" W x 1-3/8" H	
<b>TLP24VP60</b> - 60W 4-1/2" L x 2" W x 1-3/8" H	
<b>TLP24VP96</b> - 96W 6-1/8" L x 2-3/8" W x 1-1/2" H	

## 24V Hardwire Power Supplies



### TLP24VHW Series

#### Hardwire Power Supply

120VAC/24VDC. Includes stripped and tinned wire pigtails on the input and output sides. MUST BE MAINTAINED WITHIN AN ENCLOSURE THAT MEETS LOCAL BUILDING CODES AND NEC (SUPPLIED BY OTHERS). 1 Ft Wire leads. Class 2 recognized.

For use with 24V LED Tapelight.



### TLP24VHW \* MV-ENC Series

#### Hardwire Class 2 Constant Voltage Driver

120 – 277VAC/24VDC Dimming and non-dimming Class 2 Constant Voltage LED Drivers. UL Listed enclosure with built-in junction boxes. No minimum load requirement. Auto-reset protection for short circuit and over-temperature. Over load protection in CC mode. 0–10V Dimming driver delivers smooth flicker free linear dimming down to 1% with most LEDs and a wide variety of compatible dimmers.

0–10V Driver dimming not recommended when using TW/RGB/RGBW controllers.

For use with 24V LED Tapelight.

#### TLP24VHW20

20W 24V 120VAC: 5-3/4" L x 1-1/2" W x 1-1/4" D

#### TLP24VHW60

60W 24V 120VAC: 6-1/3" L x 1-3/4" W x 1-1/4" D

#### TLP24VHW96

96W 24V 120VAC: 8-3/4" L x 2-2/3" W x 1-1/2" D

Quantity



### TLP24VHW \* -ENC Series

#### Hardwire Class 2 Enclosed Driver

120VAC/24VDC. Dimmable Class 2 listed driver. Compact self-enclosed driver with two (2) knockouts. Auto Reset and short circuit protection. Dimmable with standard MLV/Incandescent TRIAC (Leading Edge) dimmers; 8W Min. load required for smooth dimming.

TRIAC Driver dimming not recommended when using TW/RGB/RGBW controllers.

For use with 24V LED Tapelight.

#### TLP24VHW60MV-ENC

60W 24V 120-277VAC, Non-Dimming Driver

#### TLP24VHW60MVD2-ENC

60W 24V 120-277VAC, 0-10V Dimming Driver

#### TLP24VHW96MV-ENC

96W 24V 120-277VAC, Non-Dimming Driver

#### TLP24VHW96MVD2-ENC

96W 24V 120-277VAC, 0-10V Dimming Driver

Quantity

#### TLP24VHW20-ENC

20W 24V 120VAC: 6-3/4" L x 2-2/3" W x 1-1/4" D

#### TLP24VHW60-ENC

60W 24V 120VAC: 6-3/4" L x 2-2/3" W x 1-1/4" D

#### TLP24VHW96-ENC

96W 24V 120VAC: 6-3/4" L x 2-2/3" W x 1-1/4" D

#### TLP24VHW96-ENC277V

96W 24V 277VAC: 10" L x 3" W x 3" D

Quantity



### L3D0 Series

#### Hardwire Hi-Lume Premier Driver

Enclosed Class 2 96W Constant Voltage Driver with dimming down to 0.1% with compatible controls. Universal 120 - 277VAC input. Output wattage range 25-96W.

For use with 24V LED Tapelight.

#### L3D0-96W24V-U

96W 24V 120-277VAC: 5.5" W x 2" H x 10.5" L

Quantity

DATE

PROJECT

TYPE

# PERFORMANCE LED TAPELIGHT | 12V & 24V Power Supply Accessories

## Plug-and-Play Power Connectors



### TLCEXT Series

*Plug-and-Play Power Supply Extension*

Includes male and female plug connectors.

Use with 12V or 24V Performance LED Tapelight

*Not compatible with 24V RGBW Performance LED Tapelight series*



### TLCIP Series

*Static Color Male Power Connector*

Includes one (1) male plug connector and one (1) male flex tape connector.

Use with 12V or 24V Static Color Performance LED Tapelight

TLCEXT24 - 24 IN

TLCEXT48 - 48 IN

Quantity

TLCEXT36 - 36 IN

TLCEXT96 - 96 IN

TLCIP12 - 12 IN

TLCIP19 - 19 IN

Quantity



### TLCS2

*Plug-and-Play 2-Way Splitter*

Includes one (1) male and two (2) female connectors. Approximately 2 Ft long.

Use with 12V or 24V Performance LED Tapelight

*Not compatible with 24V RGBW Performance LED Tapelight series*



### TLCOP12

*Static Color Female Power Connector*

12 In. connector includes one (1) male plug connector and one (1) female flex tape connector.

Use with 12V or 24V Static Color Performance LED Tapelight

TLCS2 - 12V/24V Plug-and-Play 2-Way Splitter

Quantity

TLCOP - 12 Inch 12V/24V Static Color Female Power Connector

Quantity



### TLCS3

*Plug-and-Play 3-Way Splitter*

Includes one (1) male and three (3) female connectors. Approximately 2 Ft long.

Use with 12V or 24V Performance LED Tapelight

*Not compatible with 24V RGBW Performance LED Tapelight series*

TLCS3 - 12V/24V Plug-and-Play 3-Way Splitter

Quantity

DATE PROJECT TYPE

# PERFORMANCE LED TAPELIGHT | 12V & 24V Power Supply Accessories

## Hardwire Power Connectors



**TLCFF**  
*Female Connector*  
6 Inch long connector includes a wire pigtail end and a female plug connector on the other end. Used to add plug and play female connector to hardwire power supplies.  
Use with 12V or 24V Performance LED Tapelight



**TLCIP \* HW Series**  
*Male Power Connector*  
Includes wire pigtail end and one (1) male flex tape connector.  
Use with 12V or 24V Performance LED Tapelight

TLCFF - 12V/24V Hardwire Female Connector Quantity

TLCIP12HW - 12 IN    TLCIP19HW - 19 IN    Quantity  
**TLCIP19HW-12AWG10FT**  
 19 IN Connector with Additional 10 Ft 12AWG Red & Black Wires  
**TLCIP19HW-12AWG20FT**  
 19 IN Connector with Additional 20 Ft 12AWG Red & Black Wires



**TLCCM**  
*Male Connector*  
6 Inch long connector includes a wire pigtail end and a male plug connector on the other end. Used for easy plug in connection to plug and play power supply and wire end can be connected to RGB controller at the screw terminals.  
Use with 12V or 24V Performance LED Tapelight



**TLCOP12HW**  
*Female Power Connector*  
12 In. connector includes wire pigtail end and one (1) female flex tape connector.  
Use with 12V or 24V Performance LED Tapelight

TLCCM - 12V/24V Hardwire Male Connector Quantity

TLCOPHW - 12 IN 12V/24V Hardwire Female Power Connector Quantity

## Linear Connectors



**TLCM Series**  
*Bridge Connector*  
Blank section used to bridge gaps where LEDs are not necessary.  
Use with 12V or 24V Performance LED Tapelight



**TLCX**  
*Cross Connector*  
Used to connect up to four (4) TLT segments. May be cut to create 2-way "L" connection or 3-way "T" connection.  
Use with 12V or 24V Performance LED Tapelight

TLCM2 - 2 IN    TLCM6 - 6 IN    Quantity  
 TLCM12 - 12 IN

TLCX - 12V/24V Cross Connector Quantity



**TLCFF**  
*Short Female-to-Female Connector*  
Used to connect male tapelight ends (when tapelight is cut two male ends remain)  
Use with 12V or 24V Performance LED Tapelight

TLCFF - 12V/24V Short Female-to-Female Connector Quantity