

# INSTALLATION INSTRUCTIONS | Specflex Architectural Strip Light Wet Location Series

The important safeguards and instructions here are not meant to cover all possible conditions and situations that may occur.

## IMPORTANT SAFETY INSTRUCTIONS:

- **WARNING: RISK OF FIRE AND ELECTROCUTION**
- **WARNING: TO AVOID FIRE, SHOCK OR DEATH**, disconnect power at circuit breaker before installing or servicing device
- **TO AVOID SHOCK OR ELECTROCUTION**, product must be grounded
- **READ AND SAVE THESE INSTRUCTIONS FOR LATER USE**
- Product should be installed by a qualified electrician
- All electrical connections must be in accordance with local and National Electrical Code (NEC) standards.
- Product must be mounted in locations and at heights and in a manner consistent with its intended use, in compliance with National Electrical Code and local codes and where it will not readily be subject to tampering by unauthorized personnel
- Driver is to be installed in accordance with Article 450 of the National Electric Code
- Prior to installation, check the label and ensure the Driver has the proper input voltage and wattage for the job. Check the wire markings to ensure they match the wiring diagram.
- Driver must be installed in a well-ventilated area, free from explosive gases and vapors. Proper operation requires for free flow of air.
- The power supply must meet the full load
- Use Only With Class 2 Power Unit
- Suitable for Wet Locations
- For all wire connections use only UL Listed Wire Nuts and Connectors of suitable size and type
- Wear rubber soled shoes and work on a sturdy wooden or non-conductive ladder
- Double check all connections and screws, ensuring they are tight and correct
- Most dwellings built before 1985 have supply wire rated at 60°C
- Supply conductors (power wires) connecting the fixture must be rated at minimum of 90°C
- Installing contrary to instructions may cause unsafe conditions
- If the product has any visible damage do not install it
- Call the Technical Support department at ConTech Lighting with any installation questions: 847.559.5500

## PRECAUTIONS

- **Wet Location Strip Light is not suitable for applications where the LEDs can become submerged**
- **NOTE:** DO NOT connect Strip Light to line voltage power
- **NOTE:** Always test Strip Light operation before installing  
Connect to power supply to ensure it is working properly and no damage has occurred during shipping
- Power Supply is selected based on the power and length of the selected Strip Light and run length **NOTE:** Ensure the Power Supply load is 30% higher than the strip's power
- Ensure Power Supply is compatible with the selected Strip Light model and wattage, plus the anticipated run length
- When the selected Strip Light power is over 4W/Ft, it is advised to install the strip in an Aluminum Mounting Channel which helps with heat dissipation which helps to extend the Strip Light lifetime

FIGURE 2

- Thoroughly clean the area where the Strip Light will be installed
- When installing, avoid excessive pressure on the LEDs and Resistors
- Using fingers only, apply firm, even pressure to press the Strip Light down onto the chosen flat mounting surface, making sure Strip Light is laying completely flat, any lifting will cause noticeable changes in light output
- **NOTE:** DO NOT use any tools to install the Strip Light to a surface, this will cause damage to the Strip Light

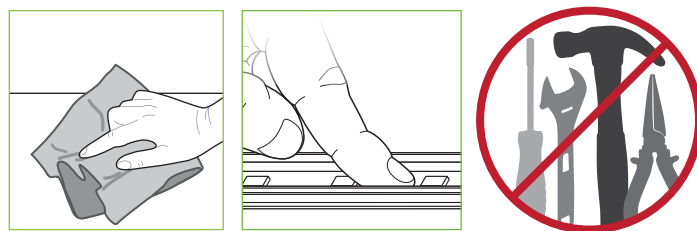
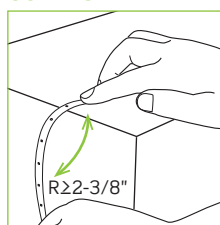

FIGURE 1

- Do not fold, crease, twist, or bend the Strip Light at sharp angles
- Use an angle greater than or equal to 90° when there is an LED chip on the corner while placing the tape in a concave position
- Use an angle greater than or equal to 60° when there is no LED chip on the corner while placing the tape in a concave position
- Use an angle greater than or equal to 60° when there is an LED chip on the corner while placing the tape in a convex position. In the convex position, the angle should not reach 90°

### CORRECT



### INCORRECT

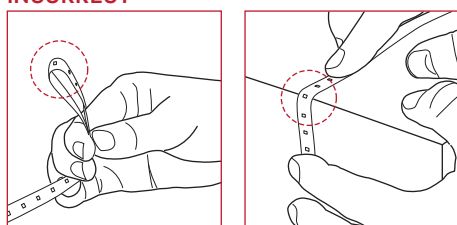

# INSTALLATION INSTRUCTIONS | Specflex Architectural Strip Light Wet Location Series

*The important safeguards and instructions here are not meant to cover all possible conditions and situations that may occur.*

## INSTALLATION PROCEDURE

### ADHESIVE BACKING

- Determine the amount of Strip Light needed for the application; if needed, cut the Strip Light to the required length, cutting only on the marked cut lines
- After cutting, place a silicone Endcap on the end of the cut length using silicone adhesive
- Cutting the Strip Light terminates conductivity on the non-powerfeed end
- To ensure the cap comes into direct contact with the Strip Light, slice and remove 5/8-inch of the Silicone Sleeve and Double-Sided 3M™ adhesive backing; any remaining inside the Endcap can prevent a water-tight seal
- Apply a small bead of silicone sealant all the way around the Strip Light near the cut end; make sure the silicone does not get into the freshly cut Strip Light edge, as this will cause the LED Diode to change color
- Wipe off any excess silicone and wait a minimum of 20-30 minutes for silicone to set before handling
- Thoroughly clean the area where the Strip Light will be installed with isopropanol or denatured alcohol
- Carefully start removing the paper backing from the 3M™ Double Sided Adhesive Backing at the Connector end of the Strip Light
- Using fingers only, apply firm, even pressure to press the Strip Light down onto the chosen flat mounting surface, making sure Strip Light is laying completely flat, any lifting will cause noticeable changes in light output
- Avoid excessive pressure on the LEDs and Resistors
- **NOTE:** DO NOT use any tools, this will cause damage to the Strip Light
- Do not remove all the paper backing at once; remove slowly down the length of the Strip Light, gently pressing the Strip Light into place as you go
- After 72 hours, full bond strength between the surfaces is achieved; for additional support, use silicone clips every 24-inches to secure Wet Location Strip Light to mounting surface
- **NOTE:** Wet Location Strip Light has 3M™ VHB Double Sided Adhesive Backing and cannot be repositioned without damaging the VHB Adhesive Strip
- Install and secure the Wet Location Listed Power Supply in a well-ventilated area, free from explosive gases and vapors; proper operation requires free flow of air
- Ensure the Power Supply meets the full load
- Power Supply should be placed in a weather-proof, code approved enclosure supplied by others
- Connect Strip Light to the Power Supply via chosen terminal end:
  - Female Barrel Connector
  - Male Barrel Connector
  - Factory Soldered Lead Wires
- Consult Wiring Diagrams for details
- Turn on the power to light the Strip Light up

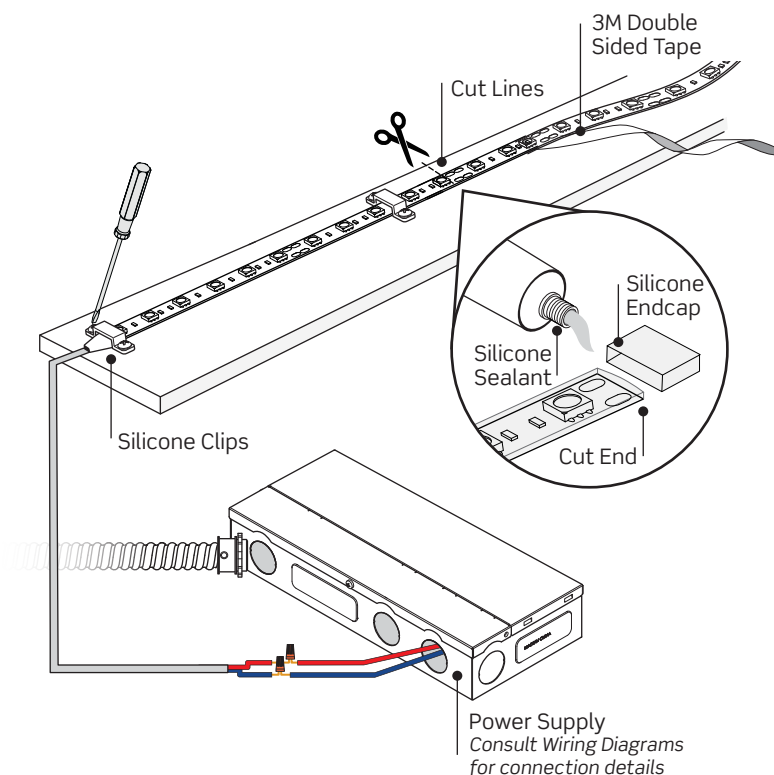

# INSTALLATION INSTRUCTIONS | Specflex Architectural Strip Light Wet Location Series

*The important safeguards and instructions here are not meant to cover all possible conditions and situations that may occur.*

## INSTALLATION PROCEDURE

### MOUNTING CHANNELS

Wet Location Strip Light is compatible with the following Mounting Channels:

- Extra Wide Recessed Mounting Channel (AFEX2011R)
- Wide Mounting Channel (AFEX1508S)
- Extra Wide Mounting Channel (AFEX2011S)
- 45° Angled Wide Mounting Channel (AFEX1318A)

#### • ALWAYS WEAR SAFETY GLASSES WHEN CUTTING THE MOUNTING CHANNELS

- Determine the length of Mounting Channel needed for the application; standard Channel length is 6 feet
- Before cutting the Channel, secure the cutting point with masking tape
- Cut Mounting Channel using a Hacksaw or Miter Saw with the appropriate blade for cutting Aluminum
- If installing Strip Light inside a Channel that will be facing up, 1/16- to 1/8-inch drainage holes should be drilled along the inner corner of the Channel every 24-inches before installing the Strip Light.

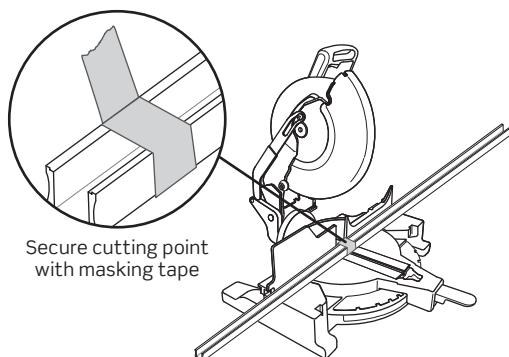

Secure cutting point with masking tape

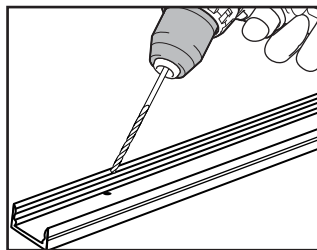

Drill drainage holes along the inner corner of the Channel if it will be mounted facing upwards

### MOUNTING CHANNEL: SURFACE MOUNT

- If installing Strip Light inside a Channel that will be facing up, 1/16- to 1/8-inch drainage holes should be drilled along the inner corner of the Channel every 24-inches before installing the Strip Light.
- Mark mounting locations along the inside bottom of the Channel; recommended max. distance between locations is 24-inches
- Drill counter sunk holes through the Channel at the marked points; Screws must be flush with inside bottom of Channel
- Ensure there are no burrs around the holes after drilling as they can damage the Strip Light and Power Cables
- Screw Channel through counter sunk holes directly onto the mounting surface, ensuring Screws are flush with the inside bottom of Channel
- Thoroughly clean the inside of the Mounting Channel, then install Strip Light directly into the channel

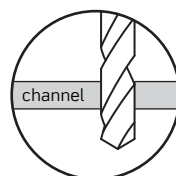
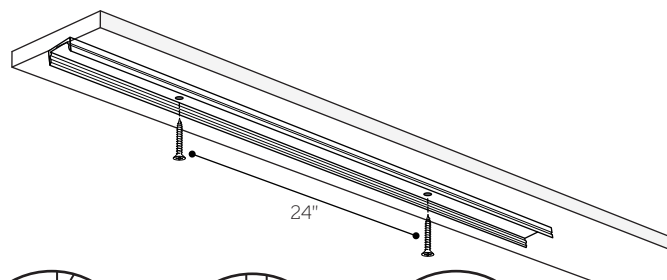

Drill through Channel

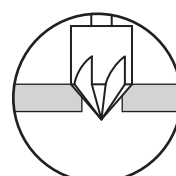

Countersink Holes

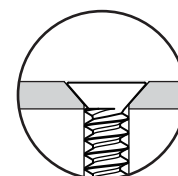

Tighten Screws below Channel surface

### MOUNTING CHANNEL: MOUNTING CLIPS

- Mark Mounting Clip locations along Strip Light run; recommended max. distance between clips is 24-inches
- If installing Strip Light inside a Channel that will be facing up, 1/16- to 1/8-inch drainage holes should be drilled along the inner corner of the Channel every 24-inches before installing the Strip Light
- Secure Clips with screw(s) directly onto mounting surface
- Install Strip Light directly into the Mounting Channel
- Snap Mounting Channel into Clips

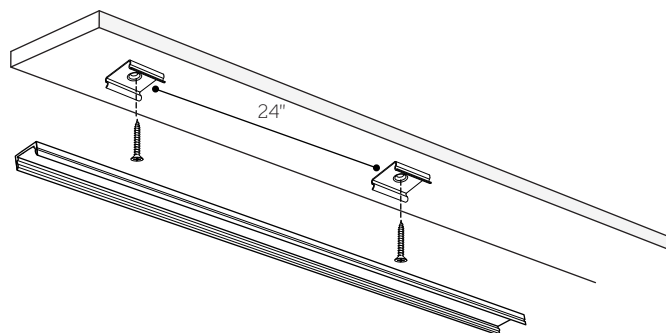

# INSTALLATION INSTRUCTIONS | Specflex Architectural Strip Light Wet Location Series

The important safeguards and instructions here are not meant to cover all possible conditions and situations that may occur.

## MOUNTING CHANNEL: RECESSED

- Determine which Recessed Mounting Channel is to be used and the direction it will be mounted
- If mounting facing upwards/on top of surface or horizontally, no Mounting Clips are required; it is advised to secure the Mounting Channel into the slot using Mounting Clips, with Double-Sided Adhesive Tape, or by drilling screws directly through the back of the Channel into the slot
- In addition, if the Channel will be facing upwards, 1/16- to 1/8-inch drainage holes should be drilled along the inner corner of the Channel every 24-inches before installing the Strip Light
- If mounting facing downwards/on the bottom of the surface, Mounting Clips secured with Screws or securing the Channel directly through the back of the Channel into the slot is required to secure the Channel within the slot
- If no Mounting Clips are available for the chosen Channel and mounting direction, secure Channel into path with Double-Sided Adhesive Tape or by drilling screws directly through the back of the Channel into the slot
- Determine the width and depth of the slot to be routed into the surface
- After routing, clear the slot of dust and debris
- Install Strip Light directly into the Mounting Channel

If mounting facing upwards or horizontally, no Mounting Clips or Screws are required

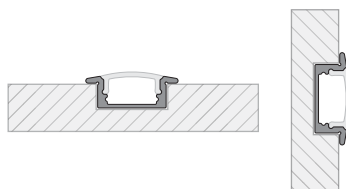

If mounting downwards, Mounting Clips secured with Screws or securing the Channel directly into the slot is required

If Mounting Clips are not available, secure Channel into path with Double-Sided Adhesive Tape or by screwing the Channel directly into the slot

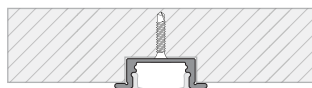

## RECESSED MOUNTING CHANNEL DIMENSIONS

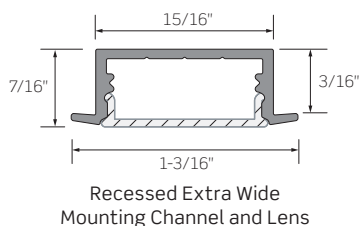

## PLACING STRIP LIGHT INTO THE CHANNEL

- Thoroughly clean the inside of the Mounting Channel with isopropanol or denatured alcohol
- Determine the amount of Strip Light needed for the application; if needed, cut the Strip Light to the required length, cutting only on the marked cut lines
- Cutting the Strip Light terminates conductivity on the non-powerfeed end
- After cutting, place a silicone Endcap on the end of the cut length using silicone adhesive
- To ensure the cap comes into direct contact with the Strip Light, slice and remove 5/8-inch of the 3M™ Double-Sided Adhesive Tape; any Tape remaining inside the Endcap can prevent a water-tight seal
- Apply a small bead of silicone adhesive sealant all the way around the Strip Light near the cut end; make sure the silicone does not get into the freshly cut tape edge, as this will cause the LED to change color
- Wipe off any excess silicone and wait a minimum of 20-30 minutes for silicone to set before handling
- Carefully start removing the paper backing from the 3M™ Double-Sided Adhesive Tape at the Connector end of the Strip Light
- Do not remove all the paper backing at once; remove slowly down the length of the Strip Light, gently pressing the Strip Light into place as you go
- Using fingers only, apply firm, even pressure to press the Strip Light down into the Channel, making sure the Strip Light is laying completely flat; any lifting will cause noticeable changes in light output
- Avoid excessive pressure on the LEDs and Resistors
- **NOTE:** DO NOT use any tools, this will cause damage to the Strip Light
- After 72 hours, full bond strength between the surfaces is achieved; for additional support, use silicone clips every 24-inches to secure Wet Location Strip Light to mounting surface
- **NOTE:** Wet Location Strip Light has 3M™ VHB Double-Sided Adhesive Tape and cannot be repositioned without damaging the VHB Tape

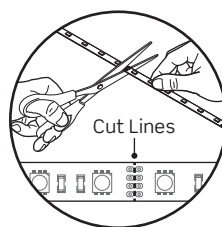

If needed, adjust Strip length; cut only on marked cut lines

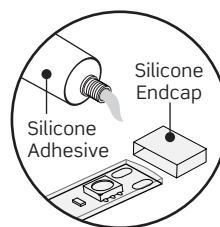

Apply Endcap to newly cut end

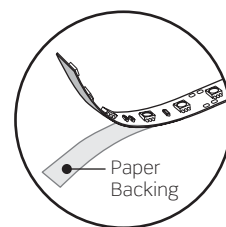

Slowly remove Paper Backing

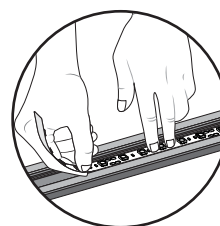

Gently press the Strip Light into place



Do Not use Tools to install Strip into Channel

## INSTALLATION INSTRUCTIONS | Specflex Architectural Strip Light Wet Location Series

*The important safeguards and instructions here are not meant to cover all possible conditions and situations that may occur.*

### FINISHING THE INSTALLATION

- Install and secure the Power Supply in a well-ventilated area, free from explosive gases and vapors; proper operation requires free flow of air
- Ensure the Power Supply meets the full load of the run
- Feed Strip Light Power Cables through the opening in the single Endcap
- Connect Strip Light to the 24VDC Class 2 LED Driver/Power Supply using the Factory Soldered Lead Wires
- Consult Wiring Diagrams for details
- Turn on the power to light up the Strip Light

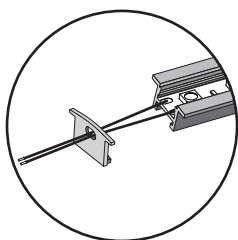

Feed Power Cables through the opening in the Endcap

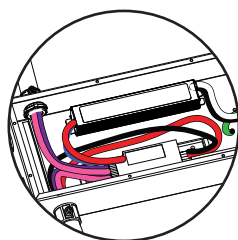

Connect Strip Light to the 24VDC Class 2 LED Driver/Power Supply

### LENS AND ENDCAPS

- Lensing is not necessary when using the Wet Location Strip Light
- If using a Lens, align the Lens starting at one corner of the interior of the Mounting Channel, carefully snap the other corner in place
- Once one corner is fully in place apply even pressure on both side of the Lens at the same time to fit the remaining Lens length in place
- Install closed endcap by snapping into place
- Turn on the power to light up the Strip Light

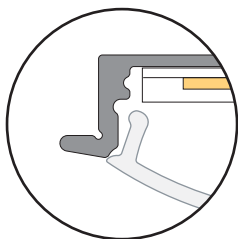

Align Lens in one corner then snap the other corner into place



Turn on Power